

ALDI PARK

BEING A REPLAT OF COUNTRY WEST AS RECORDED IN PLAT BOOK 40, PAGES 179 & 180, OF THE PUBLIC RECORDS OF PALM BEACH COUNTY, FLORIDA, LYING IN THE NORTHEAST ONE-QUARTER OF SECTION 25, TOWNSHIP 43 SOUTH, RANGE 41 EAST, VILLAGE OF ROYAL PALM BEACH, PALM BEACH COUNTY, FLORIDA ALONG WITH THE SOUTHEAST ONE-QUARTER OF THE NORTHWEST ONE-QUARTER OF THE NORTHEAST ONE-QUARTER OF SECTION 25, TOWNSHIP 43 SOUTH, RANGE 41 EAST, PALM BEACH COUNTY, FLORIDA

20

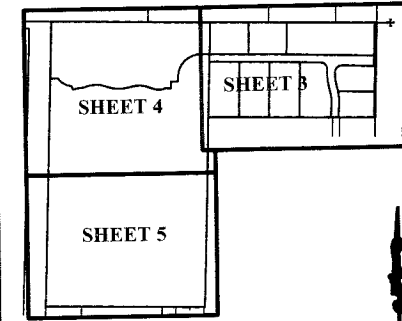

KEY MAP
NOT TO SCALE

STATE OF FLORIDA
COUNTY OF PALM BEACH
THIS PLAT WAS FILED FOR
RECORD AT _____ M.
THIS _____ DAY OF _____
A.D. 20____ AND DULY RECORDED
IN PLAT BOOK _____ ON
PAGES _____ AND _____
SHARON R. BOCK
CLERK AND COMPTROLLER
BY: _____
DEPUTY CLERK

FOUND 5/8" IRON ROD & CAP
"WALLACE LB 4396"
HELD FOR POSITION
RESET WITH 5/8" IRON ROD IN CONCRETE
WITH ALUMINUM DISK
STAMPED "ERDMAN ANTHONY PRM LB 7334"

ROYAL PALM BEACH HIGH SCHOOL
(UNPLATTED ACREAGE) (NOT INCLUDED)

PARCEL "3" (NOT INCLUDED)
FOX PROPERTIES PLAT
(P.B. 83, PG. 65)

N 88° 47' 57" W 2357.04' (TOTAL)
1149.86'

PARCEL 11
(LAKE)

CURVE DATA

CURVE	DELTA	ARC LENGTH	RADIUS
C9	89° 18' 42"	258.76'	166.00'
C10	26° 41' 57"	49.40'	106.00'
C11	37° 31' 39"	97.59'	149.00'
C12	39° 24' 24"	151.31'	220.00'
C13	36° 23' 23"	177.83'	280.00'
C14	39° 11' 56"	150.51'	220.00'
C15	17° 36' 36"	50.41'	164.00'
C16	20° 28' 55"	46.29'	129.50'
C17	49° 43' 32"	114.56'	132.00'

LINE DATA

LINE	BEARING	DISTANCE
L7	N 01° 50' 12" E	30.96'
L8	S 88° 06' 39" E	50.33'
L9	N 01° 53' 21" E	51.13'
L10	S 23° 18' 36" E	27.21'
L11	S 88° 06' 23" E	54.09'

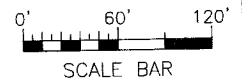

LEGEND:

- ⊙ = CENTERLINE
- C.P.B. = COUNTY OF PALM BEACH
- D.B. = DEED BOOK
- D.E. = DRAINAGE EASEMENT
- L = LENGTH
- LB = LICENSED BUSINESS
- LLC = LIMITED LIABILITY CORPORATION
- ORB = OFFICIAL RECORDS BOOK
- P = PROPERTY LINE
- P.B. = PLAT BOOK
- PCP = PERMANENT CONTROL POINT
- PG. = PAGE
- POB = POINT OF BEGINNING
- POC = POINT OF COMMENCEMENT
- PRM = PERMANENT REFERENCE MONUMENT
- PSM = PROFESSIONAL SURVEYOR & MAPPER
- R = RADIUS
- R/W = RIGHT OF WAY
- O.R.B. = OFFICIAL RECORD BOOK
- U.E. = UTILITY EASEMENT
- Δ = DELTA ANGLE
- = FOUND 4"x4" CONCRETE MONUMENT
- = SET 5/8" IRON ROD IN CONCRETE WITH ALUMINUM DISK STAMPED "ERDMAN ANTHONY PRM LB 7334"
- = SET MAG NAIL WITH DISK STAMPED "PCP LB 7334"
- ⊕ = SECTION CORNER

SHEET 4 of 7

ERDMAN ANTHONY
1402 ROYAL PALM BEACH BLVD., BLDG 500
ROYAL PALM BEACH, FLORIDA 33411
TELEPHONE 561-753-9723 FAX 561-753-9724
EB-25912 LB-7334

C.P.B. CANAL 2A
PALM BEACH COUNTY WATER CONTROL DISTRICT CANAL
SUBJECT TO O.R.B. 2108 PG. 199

S 02° 01' 18" W 2035.34' (TOTAL)

612.98'

SET 5/8" IRON ROD
IN CONCRETE WITH ALUMINUM DISK
STAMPED "ERDMAN ANTHONY PRM LB 7334"

MATCH LINE (SEE SHEET NO. 5)

PARCEL 1

MATCH LINE (SEE SHEET NO. 3)

N 01° 53' 37" E
1355.87'

THEATER SITE
(UNPLATTED)
O.R.B. 2168 PG. 1105

DRAINAGE EASEMENT
SEE SHEET NO. 7 DETAIL

MATCH LINE (SEE SHEET NO. 3)